

## Stainless Steel Take-Up Units

### Set Screw Locking

#### Material

**Housing** : SUS 440C Stainless

#### Bearing Inserts

- Inner & Outer Rings : 440C
- Retainer : 410C
- Steel Balls : 440C
- Oil Seals : 410C
- Set Screw : 440C
- Steel Plate Slinger : 410C

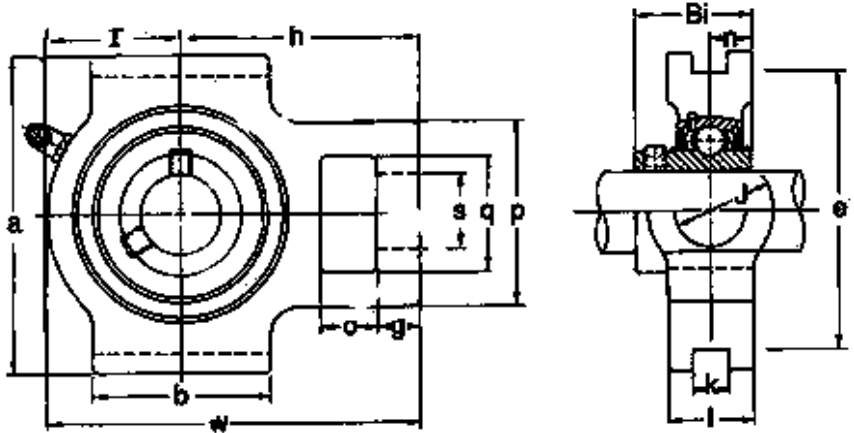

Unit No.	Shaft Dia.		Dimensions (mm/inch)														
	mm	inch	o	g	p	q	s	b	k	e	a	w	j	i	r	h	Bi
SUCT 204	20		16	10	51	32	19	51	12	76	89	94	32	21	33	61	31
SUCT 204-12		3/4	0.62	0.40	2.00	1.25	0.75	2.00	0.46	3.00	3.50	3.36	1.25	0.81	1.31	2.40	1.22
SUCT 205	25		16	10	51	32	19	51	12	76	89	97	32	24	35	62	34.1
SUCT 205-16		1	0.62	0.40	2.00	1.25	0.75	2.00	0.46	3.00	3.50	3.81	1.25	0.93	1.37	2.43	1.34
SUCT 206	30		16	10	56	37	22	57	12	89	89	113	37	28	43	70	38.1
SUCT 206-18		1-1/8	0.62	0.40	2.28	1.47	0.85	2.25	0.46	3.50	3.50	4.43	1.46	1.09	1.68	2.75	1.50
SUCT 207	35		16	13	64	37	22	64	12	89	3.50	129	37	30	51	78	42.9
SUCT 207-20		1-1/4	0.62	0.50	2.53	1.46	0.85	2.53	0.46	3.50	4.03	5.09	1.46	1.18	2.00	3.06	1.68
SUCT 207-22		1-3/8	0.62	0.50	2.53	1.46	0.85	2.53	0.46	3.50	4.03	5.09	1.46	1.18	2.00	3.06	1.68
SUCT 208	40		19	16	83	49	29	83	16	102	114	144	49	33	56	88	49.2
SUCT 208-24		1-1/2	0.75	0.62	3.28	1.93	1.14	3.28	0.62	4.03	4.50	5.65	1.93	1.31	2.21	3.46	1.93
SUCT 209	45		19	16	83	49	29	83	16	102	117	144	49	35	57	87	49.2
SUCT 210	50		19	0.62	83	1.93	1.14	3.28	0.62	102	4.59	5.65	1.93	1.37	2.25	3.15	2.03

Note: Other sizes are also available. Please contact with [fsqsales@fairfriend.com.tw](mailto:fsqsales@fairfriend.com.tw)