

for SAF200/300

1. Extra RIB to enhance the strength of housing base.
2. Solid base(SAF216-FSA217)gives extra strength at housing base.
3. Pry slot for easier dismounting housing.
4. Drain holes could be adapted with oil glass for oil lube.

SERIES SAF 200-HOUSING DIMENSIONS

Housing No. * † ‡	A	B	b	G	E		E1	H	L	2-Bolt Base		4-Bolt Base		Bolts (No. Req'd)		Wt. in	D	F
	h13	in.	in.	in.	in.	Max. in.	Min. in.	in.	in.	in.	u	v	u1	v1	in.	lbs. *	H7 mm	mm
SAF 216†	3-1/2	13	3-1/2	1-1/4	11	9-5/8	2-1/8	6-15/16	5-3/8	22.2	39.7	19.0	36.5	(2)-3/4 (4)-5/8	23.6	140	43	
SAF 217†	3-3/4	13	3-1/2	1-1/4	11	9-7/8	2-1/8	7-3/8	5-3/8	22.2	36.5	19.0	33.3	(2)-3/4 (4)-5/8	29.5	150	46	
SAF 218†	4	13-3/4	3-7/8	1-5/16	11-5/8	10-3/8	2-1/8	7-3/4	5-3/4	22.2	38.1	19.0	34.9	(2)-3/4 (4)-5/8	35.5	160	50	
SAF 220†	4-1/2	15-1/4	4-3/8	1-3/4	13-1/8	11-5/8	2-3/8	8-3/4	6	25.4	44.5	22.2	41.2	(2)-7/8 (4)-3/4	52.2	180	56	
SAF 222	4-15/16	16-1/2	4-3/4	2	14-1/2	12-5/8	2-3/4	9-5/8	6-1/2	-	-	22.2	46.0	(4)-3/4	66.7	200	63	
SAF 224	5-1/4	16-1/2	4-3/4	2-1/8	14-1/2	13-1/4	2-3/4	10-1/4	7-3/8	-	-	22.2	38.0	(4)-3/4	70.3	215	68	
SAF 226	6	18-3/8	5-1/8	2-3/8	16	14-5/8	3-1/4	11-1/2	8	-	-	25.4	42.9	(4)-7/8	106.2	230	74	
SAF 228	6	20-1/8	5-7/8	2-3/8	17-1/8	16	3-3/8	11-3/4	7-5/8	-	-	28.4	42.7	(4)-1	116.5	250	78	
SAF 230	6-5/16	21-1/4	6-1/4	2-1/2	18-1/4	17	3-3/4	12-1/2	8-3/8	-	-	28.4	44.3	(4)-1	151.1	270	83	
SAF 232	6-11/16	22	6-1/4	2-5/8	19-1/4	17-3/8	3-3/4	13-5/16	8-3/4	-	-	28.4	52.3	(4)-1	174.8	290	90	
SAF 234	7-1/16	24-3/4	6-3/4	2-3/4	21-5/8	19-3/8	4-1/4	14-3/16	9-5/8	-	-	28.4	57.0	(4)-1	184.7	310	96	
SAF 236	7-1/2	26-3/4	7-1/8	3	23-5/8	20-7/8	4-5/8	14-7/8	10	-	-	28.4	63.3	(4)-1	218.5	320	96	
SAF 238	7-7/8	28	7-1/2	3-1/8	24-3/8	21-5/8	4-1/2	15-11/16	10-3/4	-	-	35.0	66.8	(4)-1 1/4	293.3	340	102	
SAF 240	8-1/4	29-1/2	8	3-3/8	25	22-1/2	5	16-1/2	11-1/4	-	-	35.0	66.8	(4)-1 1/4	352.6	360	108	
SAF 244	9-1/2	32-3/4	8-3/4	3-3/4	27-7/8	24-3/4	5-1/4	18-5/8	12	-	-	42.8	82.5	(4)-1 1/2	439.3	400	118	

SERIES SAF 300-HOUSING DIMENSIONS

Housing No. * † ‡	A	B	b	G	E		E1	H	L	2-Bolt Base		4-Bolt Base		Bolts (No. Req'd)		Wt. in	D	F
	h13	in.	in.	in.	in.	Max. in.	Min. in.	in.	in.	in.	u	v	u1	v1	in.	lbs. *	H7 mm	mm
SAF 308	2-1/2	8-1/4	2-3/8	1	7	6-1/2		4-13/16	4	16.0	25.5	-	-	(2)-1/2	11.5	90	42.8	
SAF 309	2-3/4	9-5/8	2-3/4	1	7-7/8	7-3/8		5-5/16	4-1/4	19.0	25.4	-	-	(2)-5/8	14.7	100	46	
SAF 310	3	10-5/8	2-3/4	1-1/8	9	7-3/4		5-13/16	4-5/8	19.0	34.9	-	-	(2)-5/8	18.3	110	51	
SAF 311†	3-1/4	11	3-1/8	1-3/16	9-1/2	8-1/8	2	6-3/16	5	19.0	36.5	16.0	33.5	(2)-5/8 (4)-1/2	20.8	120	53	
SAF 313†	3-1/2	13	3-1/2	1-1/4	11	9-5/8	2-1/8	6-15/16	5-3/8	22.2	36.7	19.0	36.5	(2)-3/4 (4)-5/8	29.5	140	58	
SAF 314	3-3/4	12-9/32	3-1/2	1-1/4	11	9-7/8	2-1/8	7-3/8	4-31/32	22.2	36.7	19.0	36.5	(2)-3/4 (4)-5/8	29.5	150	61	
SAF 315	4	13-3/4	3-7/8	1-5/16	11-5/8	10-3/8	2-1/8	7-13/16	6-1/4	22.2	38.1	19.0	34.9	(2)-3/4 (4)-5/8	40.8	160	65	
SAF 316	4-1/4	14-1/4	3-7/8	1-5/16	12-5/8	10-5/8	2-1/8	8-1/4	6-1/2	22.2	47.6	19.0	44.4	(2)-3/4 (4)-5/8	51.3	170	68	
SAF 317	4-1/2	15-1/4	4-3/8	1-3/4	13-1/8	11-5/8	2-3/8	8-3/4	6-3/4	25.4	44.5	22.2	41.3	(2)-7/8 (4)-3/4	55.3	180	70	
SAF 318	4-3/4	15-1/2	4-3/8	2	13-1/2	12	2-1/4	9-3/16	6-7/8	-	-	22.2	41.3	(4)-3/4	64.9	190	74	
SAF 320	5-1/4	16-1/2	4-3/4	2-1/8	14-1/2	13-1/4	2-3/4	10-1/4	7-3/8	-	-	22.2	38.1	(4)-3/4	80.3	215	83	
SAF 322	6	18-3/8	5-1/8	2-3/8	16	14-5/8	3-1/4	11-1/2	8	-	-	25.4	42.9	(4)-7/8	99.4	240	90	
SAF 324	6-5/16	21-1/4	6-1/4	2-1/2	18-1/4	17	3-3/4	12-1/2	8-3/8	-	-	28.4	44.3	(4)-1	146.4	260	96	
SAF 326	6-11/16	22	6-1/4	2-5/8	19-1/4	17-3/8	3-3/4	13-5/16	8-3/4	-	-	28.4	55	(4)-1	181.6	280	103	
SAF 328	7-1/16	24-3/4	6-3/4	2-3/4	21-5/8	19-3/8	4-1/4	14-3/16	9-5/8	-	-	28.4	57.0	(4)-1	214.0	300	112	
SAF 330	7-1/2	26-3/4	7-1/8	3	23-5/8	20-7/8	4-5/8	14-7/8	9-3/4	-	-	28.4	63.3	(4)-1	256.6	320	118	
SAF 332	7-7/8	28	7-1/2	3-1/8	24-3/8	21-5/8	4-1/2	15-11/16	10-3/4	-	-	35.0	66.8	(4)-1 1/4	298.3	340	124	
SAF 334	8-1/4	29-1/2	8	3-3/8	25	22-1/2	5	16-1/2	11-1/4	-	-	35.0	66.8	(4)-1 1/4	355.7	360	130	
SAF 336	8-7/8	31-1/4	8-1/4	3-1/2	26-5/8	24	5-1/4	17-3/4	11-3/8	-	-	35.0	68.4	(4)-1 1/4	380.3	380	136	
SAF 338	9-1/2	32-3/4	8-3/4	3-3/4	27-7/8	24-3/4	5-1/4	18-5/8	12	-	-	42.8	82.55	(4)-1 1/2	449.6	400	142	
SAF 340	9-7/8	34-1/4	9	4	29-1/2	26-1/4	5-1/2	20	12-1/16	-	-	42.8	82.55	(4)-1 1/2	493.0	420	148	

Notes: For stepped shaft bore, use SAFZ2xx/SAFZ3xx
For same shaft bore, use SAF2xx/SAF3xx

NOTES:

* Basic housing does not include bearing and accessories. The weight is subject to change.

§ For float unit application, order 1-housing, 2-labyrinth seals, 1-locknut and 1-lockwasher. For fixed unit application, add 1-stabilizing ring to the above.

† 4-hole base is also available and must be marked with a prefix F . SAF 222 and SAF 318 and up are standard 4-hole base.

※ LOR is also available

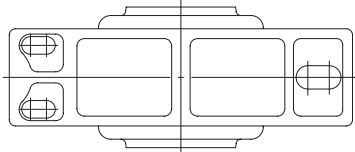

for SAF216~217
SAF 308~317

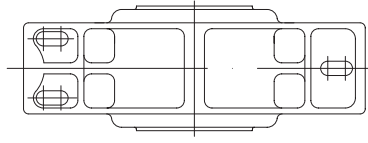

for SAF218~244
SAF 318~340

SERIES SAF 222-PILLOW BLOCK PART NUMBERS

Shaft Dia.						Complete Pillow Block Number	Pillow Block Housing Only	Bearing Number	Lock-nut	Lock-washer	Labyrinth Seal Ring		Stabilizing Ring (1 Req'd)	End Plug (EPR)
S-2 in.	d2(H12) mm	d3(H12) mm	S-3 in.	d2(H12) mm	d3(H12) mm						S-2 Shaft (1 Req'd)	S-3 Shaft (1 Req'd)		
3-5/8	96.9	110.06	3	83.7	96.85	SAF 22216	SAF 216	22216	N 16	W 16	LER 82	LER 54	SR-16-13	9
3-15/16	106.43	119.59	3-3/16	90.55	103.71	SAF 22217	SAF 217	22217	N 17	W 17	LER 89	LER 63	SR-17-14	9
4-1/8	113.8	132.84	3-3/8	91.06	110.11	SAF 22218	SAF 218	22218	N 18	W 18	LER 112	LER 191	SR-18-15	11
4-1/2	121.74	140.8	3-13/16	102.18	121.23	SAF 22220	SAF 220	22220	N 20	W 20	LER 118	LER 106	SR-20-17	12
4-7/8	132.84	151.9	4-3/16	113.8	132.84	SAF 22222	SAF 222	22222	N 22	W 22	LER 121	LER 113	SR-22-19	14
5-5/16	142.88	161.93	4-9/16	121.74	140.8	SAF 22224	SAF 224	22224	N 24	W 24	LER 127	LER 119	SR-24-20	15
5-7/8	157.18	176.23	4-15/16	132.84	151.9	SAF 22226	SAF 226	22226	N 26	W 26	LER 136	LER 122	SR-26- 0	27
6-1/4	167.46	186.51	5-5/16	142.88	161.93	SAF 22228	SAF 228	22228	N 28	W 28	LER 144	LER 127	SR-28- 0	16
6-5/8	176.99	196.04	5-3/4	157.18	176.23	SAF 22230	SAF 230	22230	N 30	W 30	LER 151	LER 134	SR-30- 0	17
7	187.53	212.93	6-1/16	161.11	186.51	SAF 22232	SAF 232	22232	N 32	W 32	LER 156	LER 142	SR-32- 0	18
7-7/16	201.8	227.2	6-7/16	172.21	197.61	SAF 22234	SAF 234	22234	N 34	W 34	LER 161	LER 148	SR-34- 0	19
7-13/16	211.84	237.24	6-7/8	187.53	212.93	SAF 22236	SAF 236	22236	N 36	W 36	LER 165	LER 154	SR-36-30	20
8-3/8	224.54	249.94	7-1/4	192.28	217.68	SAF 22238	SAF 238	22238	N 38	W 38	LER 171	LER 160	SR-38-32	21
8-3/4	234.06	259.46	7-5/8	201.8	227.2	SAF 22240	SAF 240	22240	N 40	W 40	LER 175	LER 164	SR-40-34	22
9-9/16	254.71	280.11	8-5/16	224.54	249.94	SAF 22244	SAF 244	22244	N 44	W 44	LER 179	LER 170	SR-44-38	24

SERIES SAF 223-PILLOW BLOCK PART NUMBERS

Shaft Dia.						Complete Pillow Block Number	Pillow Block Housing Only	Bearing Number	Lock-nut	Lock-washer	Labyrinth Seal Ring		Stabilizing Ring (1 Req'd)	End Plug (EPR)
S-2 in .	d2(H12) mm	d3(H12) mm	S-3 in.	d2(H12) mm	d3(H12) mm						S-2 Shaft (1 Req'd)	S-3 Shaft (1 Req'd)		
1-15/16	54.36	65.1	1-7/16	41.66	52.4	SAF 22308	SAF 308	22308	N 08	W 08	LER 24	LER 17	SR-10- 8	3
2-1/8	60.96	71.7	1-11/16	48	58.75	SAF 22309	SAF 309	22309	N 09	W 09	LER 28	LER 20	SR-11- 9	4
2-3/8	64.14	74.88	1-7/8	54.36	65.1	SAF 22310	SAF 310	22310	N 10	W 10	LER 35	LER 23	SR- 0-10	4
2-9/16	70.49	81.23	2-1/16	60.96	71.7	SAF 22311	SAF 311	22311	N 11	W 11	LER 40	LER 27	SR-13-11	6
3-1/16	83.7	96.85	2-7/16	67.82	80.98	SAF 22313	SAF 313	22313	N 13	W 13	LER 55	LER 37	SR-16-13	7
3-1/4	90.55	103.71	2-5/8	77.34	90.48	SAF 22314	SAF 314	22314	N 14	W 14	LER 64	LER 43	SR-17-14	8
3-7/16	90.55	110.06	2-13/16	77.34	90.48	SAF 22315	SAF 315	22315	N 15	W 15	LER 79	LER 46	SR-18-15	8
3-5/8	102.18	121.23	3	81.03	100.08	SAF 22316	SAF 316	22316	N 16	W 16	LER 84	LER 60	SR-19-16	10
3-15/16	106.93	125.98	3-3/16	91.06	110.11	SAF 22317	SAF 317	22317	N 17	W 17	LER 109	LER 188	SR-20-17	11
4-1/8	113.8	132.84	3-3/8	91.06	110.11	SAF 22318	SAF 318	22318	N 18	W 18	LER 112	LER 191	SR-21-18	11
4-1/2	121.74	140.8	3-13/16	102.18	121.23	SAF 22320	SAF 320	22320	N 20	W 20	LER 118	LER 106	SR-24-20	12
4-7/8	132.84	151.89	4-3/16	113.8	132.84	SAF 22322	SAF 322	22322	N 22	W 22	LER 121	LER 113	SR- 0-22	14
5-5/16	142.88	161.93	4-9/16	121.74	140.8	SAF 22324	SAF 324	22324	N 24	W 24	LER 127	LER 119	SR- 0-24	15
5-7/8	157.18	176.23	4-15/16	132.84	151.9	SAF 22326	SAF 326	22326	N 26	W 26	LER 136	LER 122	SR- 0-26	27
6-1/4	167.46	186.51	5-5/16	142.88	161.93	SAF 22328	SAF 328	22328	N 28	W 28	LER 144	LER 127	SR- 0-28	16
6-5/8	176.99	196.04	5-3/4	157.18	176.23	SAF 22330	SAF 330	22330	N 30	W 30	LER 151	LER 134	SR-36-30	17
7	187.53	212.93	6-1/16	161.11	186.51	SAF 22332	SAF 332	22332	N 32	W 32	LER 156	LER 142	SR-38-32	18
7-7/16	201.8	227.2	6-7/16	172.21	197.61	SAF 22334	SAF 334	22334	N 34	W 34	LER 161	LER 148	SR-40-34	19
7-13/16	211.84	237.24	6-7/8	187.53	212.93	SAF 22336	SAF 336	22336	N 36	W 36	LER 165	LER 154	SR- 0-36	20
8-3/8	224.54	249.94	7-1/4	192.28	217.68	SAF 22338	SAF 338	22338	N 38	W 38	LER 171	LER 160	SR-44-38	21
8-3/4	234.06	259.46	7-5/8	201.8	227.2	SAF 22340	SAF 340	22340	N 40	W 40	LER 175	LER 164	SR- 0-40	22